

Note: The limits, including the height and depths of the Works, shown in this drawing are not to be taken as limiting the obligations of the contractor under Contract.  
 Reproduced by permission of Ordnance Survey on behalf of HMSO. © Crown copyright and database rights 2023  
 Ordnance Survey Licence number 100019741

**LEGEND**

- MODEL EXTENT
- WATERCOURSES
- BUILDINGS
- 1D CHANNEL

**MAX DEPTH (M)**

<= 0.25	1.00 - 1.25
0.25 - 0.50	1.25 - 1.50
0.50 - 0.75	1.50 - 1.75
0.75 - 1.00	> 1.75



**SAFETY HEALTH AND ENVIRONMENT INFORMATION**

CONSTRUCTION
MAINTENANCE / CLEARING / OPERATION
DECOMMISSIONING / DEMOLITION

Rev	Drawn	Chkd	Rwgd	Apprvd	Date	Description
P01	TW	PW	TP	RF	02/11/2023	SUITABLE FOR INFORMATION

Designed by: TW Date: NOV 2023

Status: S2  
 Client:

Client Drawing No. \_\_\_\_\_ Revision \_\_\_\_\_  
  
 Binnies UK Limited  
 Registered Office  
 Spring Lodge, 172 Chequer Road, Hales, Chepstow, WA6 0AR UK  
 Tel: +44(0)1292 774155

Project: **ABERDULAIS FRMS**

Drawing title: **EXISTING MAX WATER DEPTH  
 1% AEP CLIMATE CHANGE  
 SHEET 1 OF 6**

Drawing scale: 1:4,000 Sheet size: A3  
 Drawing no. 4021083-BUK-ZZ-00-DR-HY-00004 Revision P01

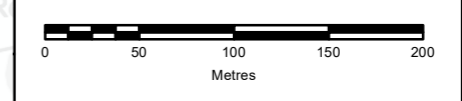

P:\Projects\4021083\_BUK\_ZZ\_00-DR-HY-00004.mxd - 20/10/2023

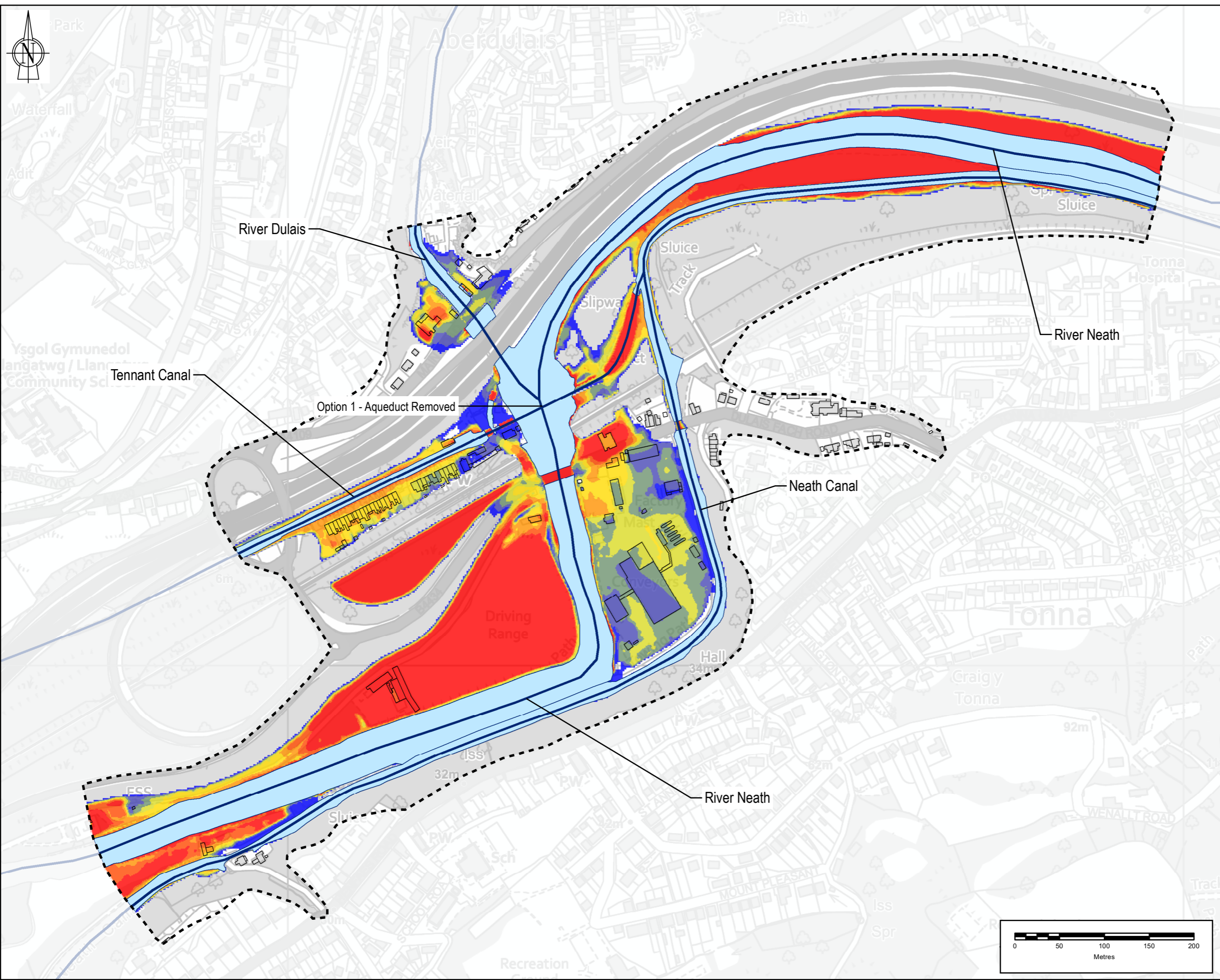

Note: The limits, including the height and depths of the Works, shown in this drawing are not to be taken as limiting the obligations of the contractor under Contract.  
 Reproduced by permission of Ordnance Survey on behalf of HMSO. © Crown copyright and database rights 2023  
 Ordnance Survey Licence number 100019741

**LEGEND**

- MODEL EXTENT
- WATERCOURSES
- BUILDINGS
- 1D CHANNEL

**MAX DEPTH (M)**

<= 0.25	1.00 - 1.25
0.25 - 0.50	1.25 - 1.50
0.50 - 0.75	1.50 - 1.75
0.75 - 1.00	> 1.75



**SAFETY HEALTH AND ENVIRONMENT INFORMATION**

CONSTRUCTION
MAINTENANCE / CLEARING / OPERATION
DECOMMISSIONING / DEMOLITION

Rev	Drawn	Chkd	Rwgd	Apprvd	Date	Description
P01	TW	PW	TP	RF	02/11/2023	SUITABLE FOR INFORMATION

Designed by: TW Date: NOV 2023

Status: S2  
 Client: **Cyfoeth Naturiol Cymru Natural Resources Wales**

Client Drawing No. \_\_\_\_\_ Revision \_\_\_\_\_  
**binnies**  
 Binnies UK Limited  
 Registered Office  
 Spring Lodge, 172 Chequer Road, Hales, Chepstow, WA6 0AR UK  
 Tel: +44(0)1297 774155

Project: **ABERDULAIS FRMS**

Drawing title: **OPTION 1 MAX WATER DEPTH  
 1% AEP CLIMATE CHANGE  
 SHEET 2 OF 6**

Drawing scale: 1:4,000 Sheet size: A3  
 Drawing no. 4021083-BUK-ZZ-00-DR-HY-00004 Revision P01

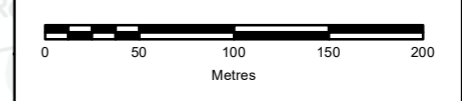

P:\Projects\4021083\_BUK\_ZZ\_00-DR-HY-00004.mxd - 20/10/2023

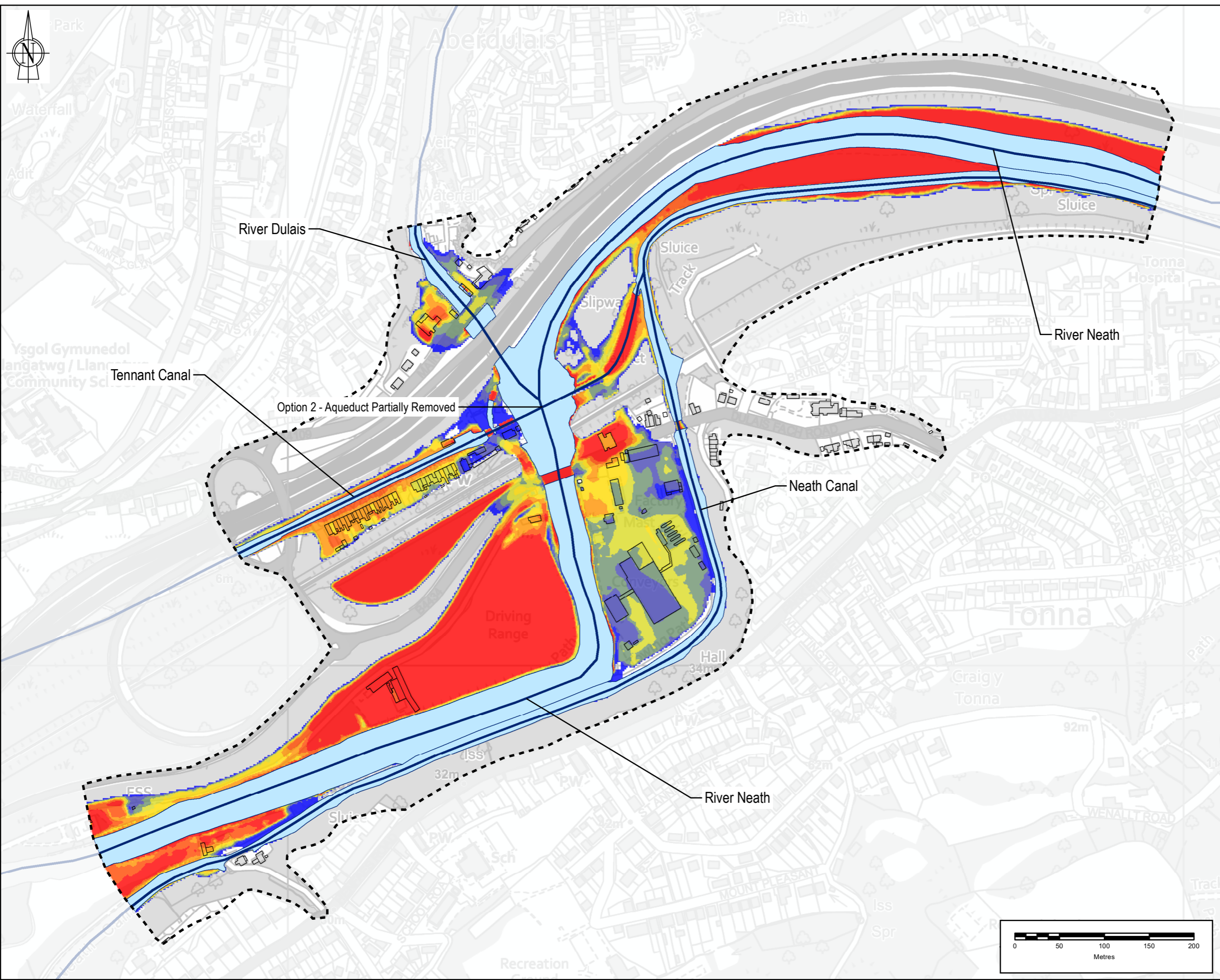

Note: The limits, including the height and depths of the Works, shown in this drawing are not to be taken as limiting the obligations of the contractor under Contract.  
 Reproduced by permission of Ordnance Survey on behalf of HMSO. © Crown copyright and database rights 2023  
 Ordnance Survey Licence number 100019741

**LEGEND**

- MODEL EXTENT
- WATERCOURSES
- BUILDINGS
- 1D CHANNEL

**MAX DEPTH (M)**

≤ 0.25	1.00 - 1.25
0.25 - 0.50	1.25 - 1.50
0.50 - 0.75	1.50 - 1.75
0.75 - 1.00	> 1.75



**SAFETY HEALTH AND ENVIRONMENT INFORMATION**

CONSTRUCTION
MAINTENANCE / CLEARING / OPERATION
DECOMMISSIONING / DEMOLITION

Rev	Drawn	Chkd	Rwgd	Apprvd	Date	Description
P01	TW	PW	TP	RF	02/11/2023	SUITABLE FOR INFORMATION

Designed by: TW Date: NOV 2023

Status: S2  
 Client:

Client Drawing No. \_\_\_\_\_ Revision \_\_\_\_\_  
  
 Binnies UK Limited  
 Registered Office  
 Spring Lodge, 172 Chequer Road, Hoby, Chepstow, WA6 6AR UK  
 Tel: +44(0)1297 774155

Project: **ABERDULAIS FRMS**

Drawing title: **OPTION 2 MAX WATER DEPTH  
 1% AEP CLIMATE CHANGE  
 SHEET 3 OF 6**

Drawing scale: 1:4,000 Sheet size: A3  
 Drawing no. 4021083-BUK-ZZ-00-DR-HY-00004 Revision P01

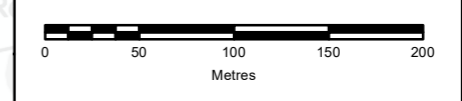

P:\Projects\4021083\_BUK\_ZZ\_00-DR-HY-00004.mxd - 20/10/2023

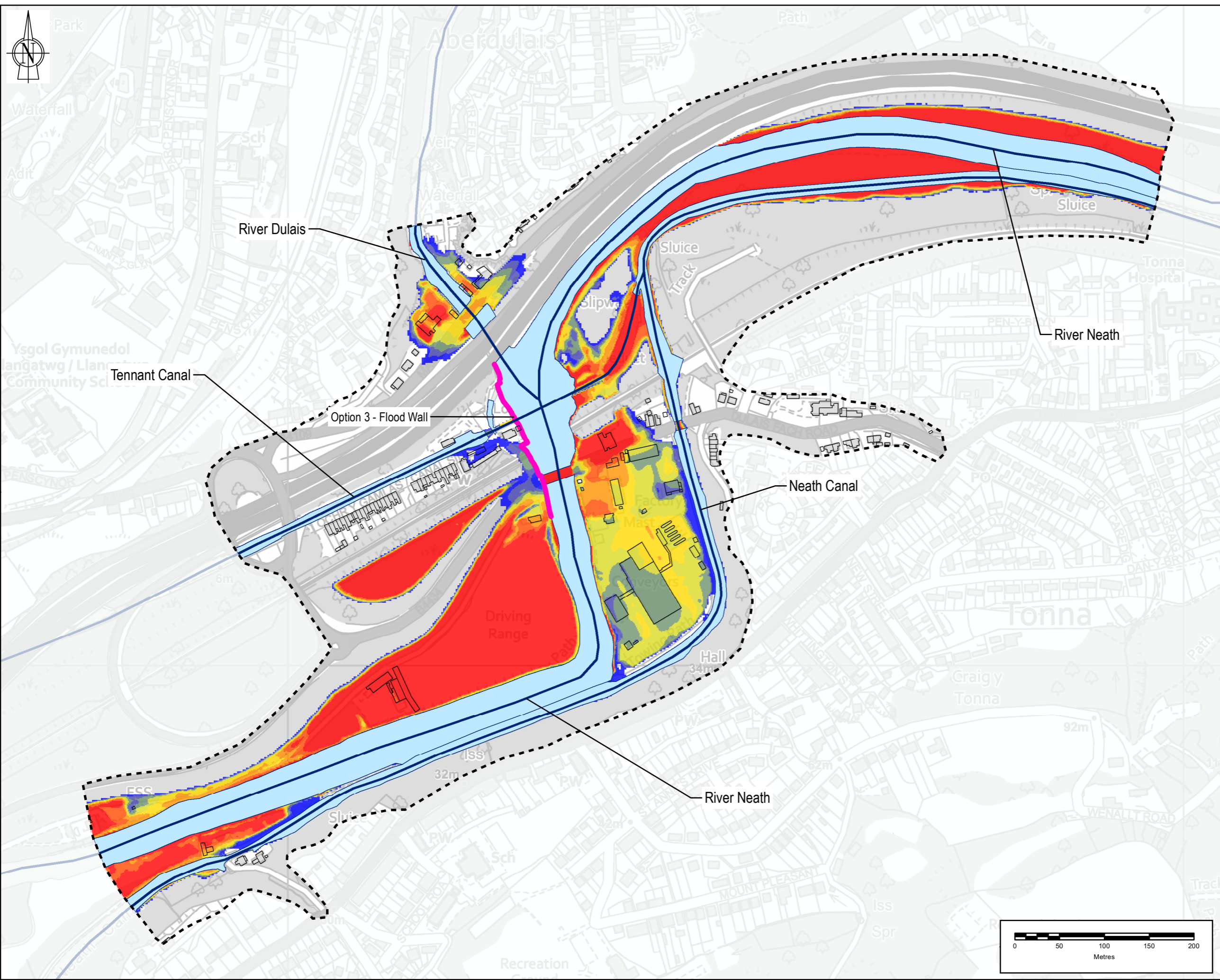

Note: The limits, including the height and depths of the Works, shown in this drawing are not to be taken as limiting the obligations of the contractor under Contract.  
 Reproduced by permission of Ordnance Survey on behalf of HMSO. © Crown copyright and database rights 2023  
 Ordnance Survey Licence number 100019741

**LEGEND**

- FLOOD WALL
- MODEL EXTENT
- WATERCOURSES
- BUILDINGS
- 1D CHANNEL

**MAX DEPTH (M)**

	<= 0.25		1.00 - 1.25
	0.25 - 0.50		1.25 - 1.50
	0.50 - 0.75		1.50 - 1.75
	0.75 - 1.00		> 1.75



**SAFETY HEALTH AND ENVIRONMENT INFORMATION**

CONSTRUCTION
MAINTENANCE / CLEARING / OPERATION
DECOMMISSIONING / DEMOLITION

Rev	Drawn	Chkd	Rwdg	Apprvd	Date	Description
P01	TW	PW	TP	RF	02/11/2023	SUITABLE FOR INFORMATION

Designed by: TW Date: NOV 2023

Status: S2  
 Client: Cyfoeth Naturiol Cymru Natural Resources Wales

Client Drawing No. \_\_\_\_\_ Revision \_\_\_\_\_  
**binnies**  
 Binnies UK Limited  
 Registered Office  
 Spring Lodge, 172 Chequer Road, Hoby, Chepstow, WA6 0AR UK  
 Tel: +44(0)1297 774155

Project: **ABERDULAIS FRMS**

Drawing title: **OPTION 3 MAX WATER DEPTH  
 1% AEP CLIMATE CHANGE  
 SHEET 4 OF 6**

Drawing scale: 1:4,000 Sheet size: A3  
 Drawing no. 4021083-BUK-ZZ-00-DR-HY-00004 Revision P01

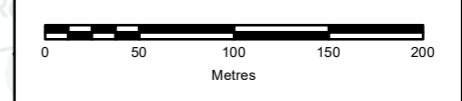

P:\Projects\4021083-BUK-ZZ-00-DR-HY-00004.mxd - 20/10/2023



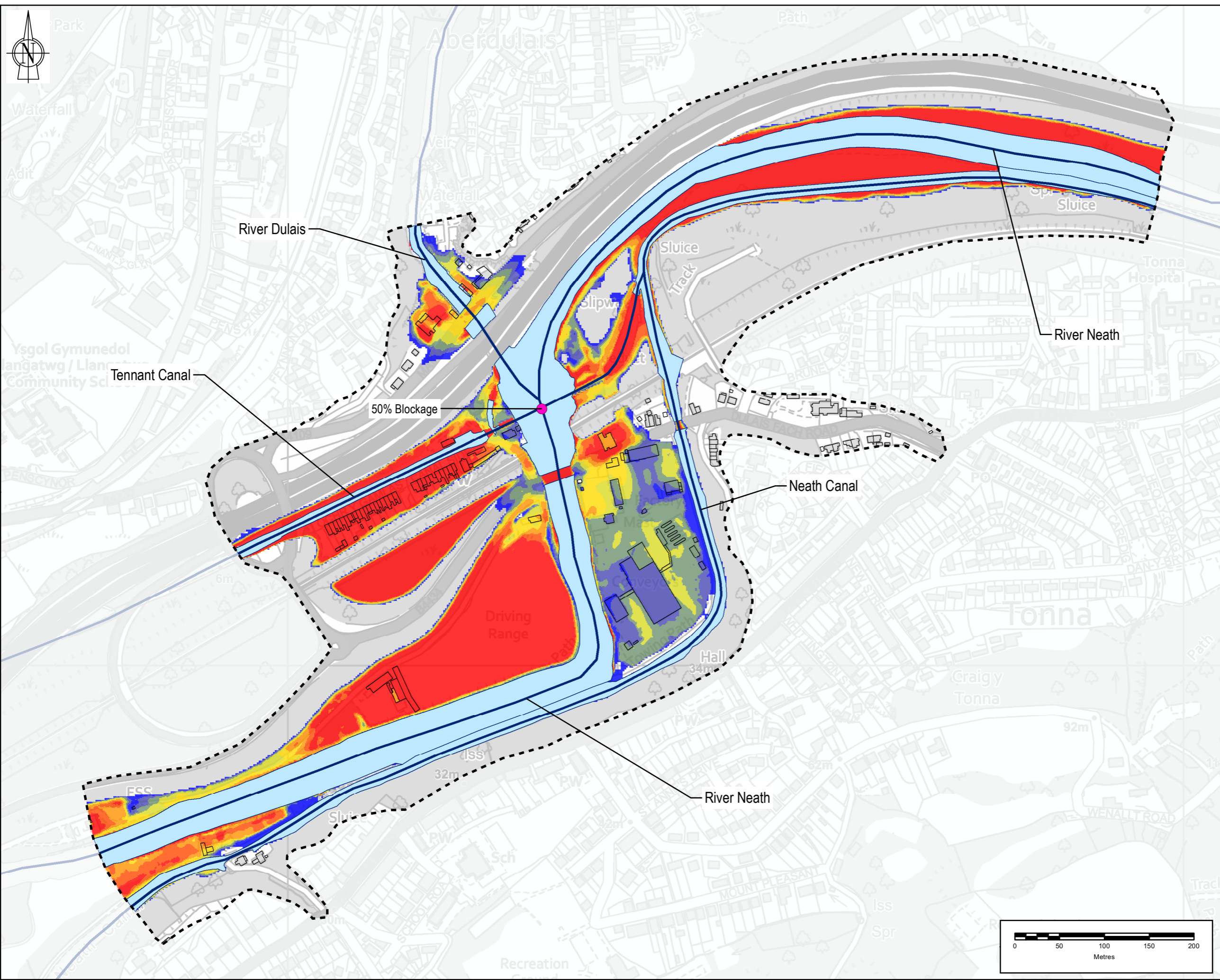

Note: The limits, including the height and depths of the Works, shown in this drawing are not to be taken as limiting the obligations of the contractor under Contract.  
 Reproduced by permission of Ordnance Survey on behalf of HMSO. © Crown copyright and database rights 2023  
 Ordnance Survey Licence number 100019741

**LEGEND**

- BLOCKAGE LOCATION
- MODEL EXTENT
- WATERCOURSES
- BUILDINGS
- 1D CHANNEL

**MAX DEPTH (M)**

	<= 0.25		1.00 - 1.25
	0.25 - 0.50		1.25 - 1.50
	0.50 - 0.75		1.50 - 1.75
	0.75 - 1.00		> 1.75



**SAFETY HEALTH AND ENVIRONMENT INFORMATION**

CONSTRUCTION
MAINTENANCE / CLEARING / OPERATION
DECOMMISSIONING / DEMOLITION

Rev	Drawn	Chkd	Rwgd	Apprvd	Date	Description
P01	TW	PW	TP	RF	02/11/2023	SUITABLE FOR INFORMATION

Designed by: TW Date: NOV 2023

Status: S2  
 Client: Cyfoeth Naturiol Cymru Natural Resources Wales

Client Drawing No. \_\_\_\_\_ Revision \_\_\_\_\_  
**Binnies UK Limited**  
 Registered Office  
 Spring Lodge, 172 Chequer Road, Hales, Chepstow, WA6 0AR UK  
 Tel: +44(0)1297 774155

Project: **ABERDULAIS FRMS**  
 Drawing title: **BLOCKAGE 3 MAX WATER DEPTH  
 1% AEP CLIMATE CHANGE  
 SHEET 6 OF 6**

Drawing scale: 1:4,000 Sheet size: A3  
 Drawing no. 4021083-BUK-ZZ-00-DR-HY-00004 Revision P01

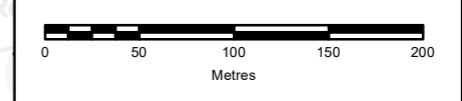

P:\Projects\4021083\_BUK\_ZZ\_00-DR-HY-00004.mxd - 20/10/2023