

PLAN OF RIVER END OF CULVERT (NETWORK RAIL ID EUB 2 32)  
SCALE 1:50

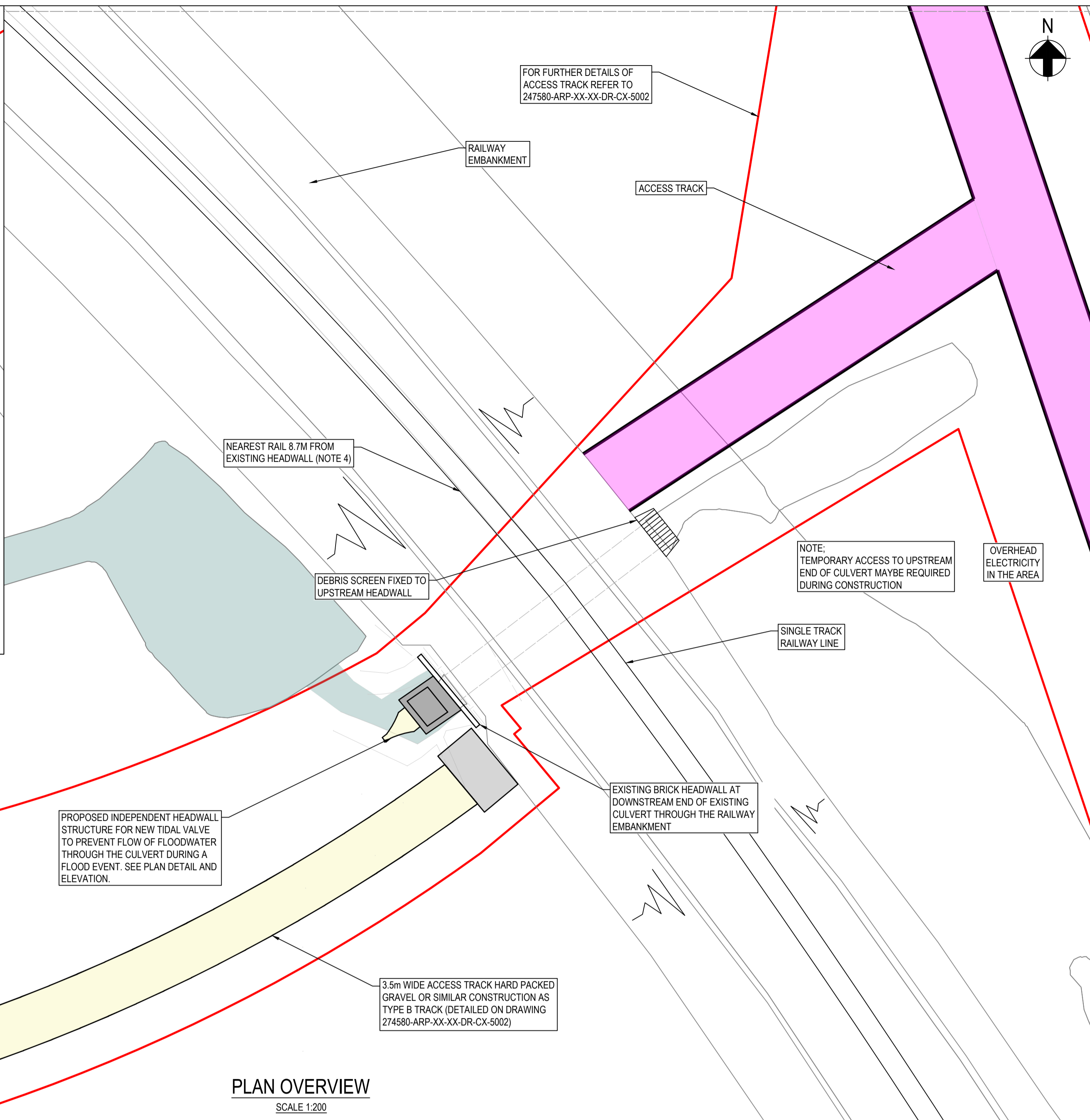

PLAN OVERVIEW  
SCALE 1:200

VIEW OF EXISTING CONTEXT  
LOOKING AT THE DOWNSTREAM END OF THE CULVERT, HEADWALL AND EXISTING FENCE PHOTO TAKEN ON SITE VISIT 2020



AERIAL VIEW OF CULVERT LOCATION  
IMAGERY(C)2021 AERODATA INTERNATIONAL SURVEYS, BLUESKY, INFOTERRA LTD & COWI A/S, GETMAPPING PLC, INFOTERRA LTD & BLUESKY, MAXAR TECHNOLOGIES, THE GEOINFORMATION GROUP, MAP DATA (C) 2021

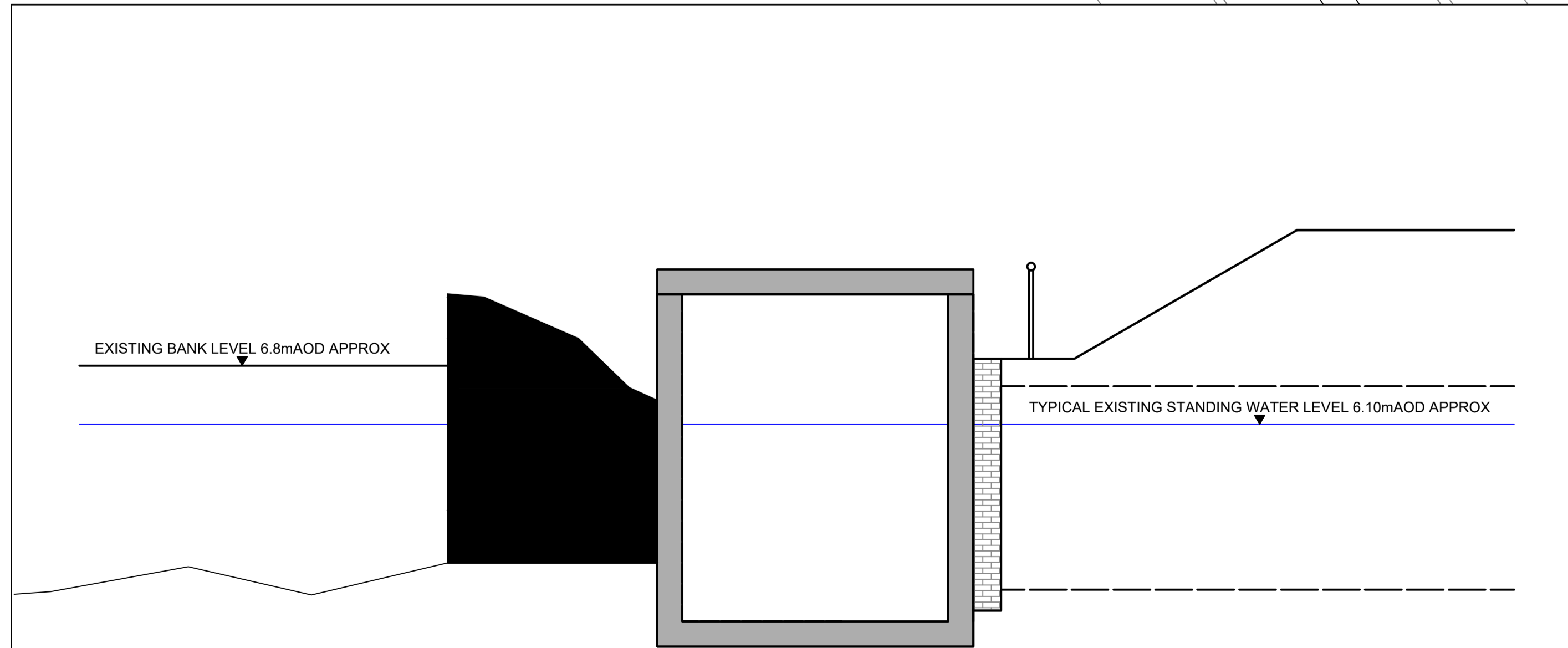

ELEVATION OF RIVER END  
CULVERT EUB 1 78.75  
SCALE 1:50

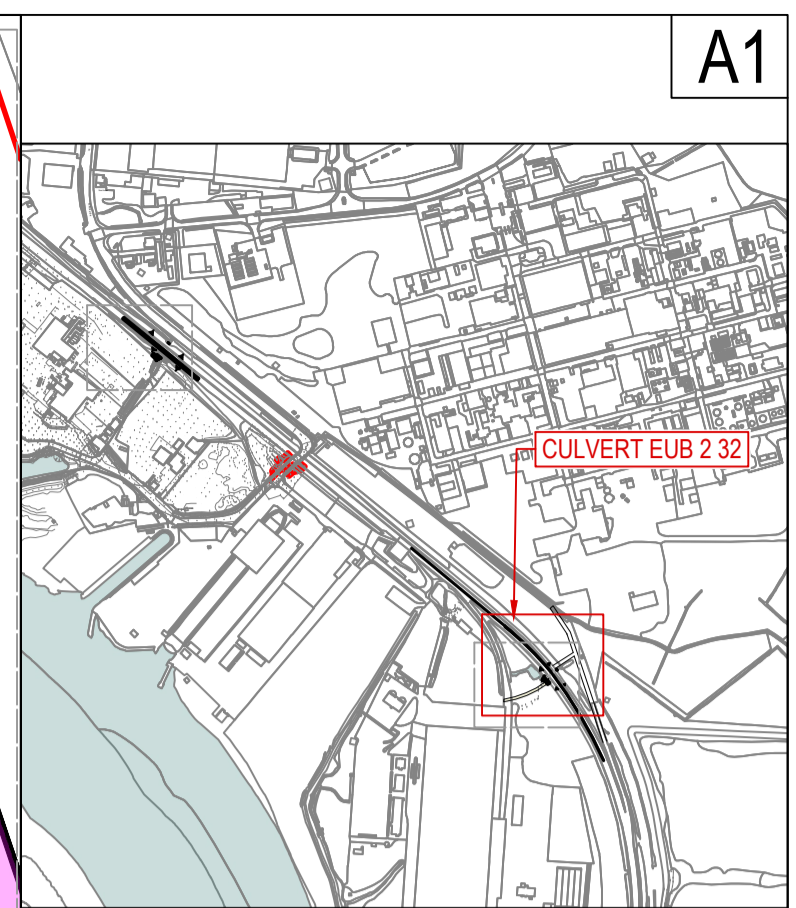

KEY PLAN  
SCALE 1:10,000

- GENERAL NOTES:**
1. THIS DRAWING IS TO BE READ IN CONJUNCTION WITH ALL OTHER DRAWINGS, SPECIFICATIONS AND CONTRACT DOCUMENTS. NOTIFY THE PROJECT MANAGER OF ANY DISCREPANCIES.
  2. ALL DIMENSIONS IN MILLIMETERS AND ALL LEVELS IN METERS ABOVE ORDNANCE DATUM UNLESS NOTED OTHERWISE.
  3. DO NOT SCALE FROM DRAWING.
  4. DIMENSIONS PROVIDED ARE APPROXIMATE AND TAKEN FROM 3RD PARTY INSPECTION REPORTS. SURVEYED VALUES TO BE USED IN CONSTRUCTION.
  5. DURING A FLOOD EVENT, WATER COULD FLOW THROUGH THE EXISTING CULVERT PASSING THROUGH THE NETWORK RAIL EMBANKMENT, RESULTING IN FLOODING ON THE NORTH-EASTERN SIDE OF THE EMBANKMENT. THEREFORE A NON-RETURN VALVE IS PROPOSED TO BE INSTALLED ON THE SOUTH-WEST END OF THE CULVERT AS PART OF THIS SCHEME. A NUMBER OF OPTIONS FOR A NON-RETURN VALVE SOLUTION ARE CURRENTLY BEING CONSIDERED. FOLLOWING THE RESULTS OF SURVEYS OF THE EXISTING CULVERT AND HEADWALLS THE MOST SUITABLE SOLUTION WILL BE SELECTED AND DEVELOPED IN ACCORDANCE WITH NETWORK RAILS GRIP PROCESS. THIS DRAWING PRESENTS THE SOLUTION THAT WOULD HAVE THE MOST SIGNIFICANT SPATIAL AND AESTHETIC IMPACT ON THE SITE WHEN COMPARED WITH ALL OTHER SOLUTIONS BEING CONSIDERED.

**LEGEND:**  
— PLANNING APPLICATION BOUNDARY

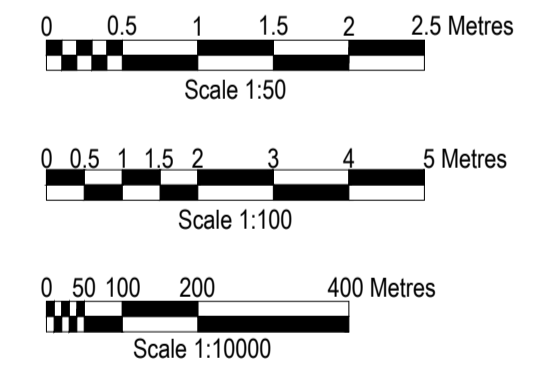

Rev.	Description	Drawn	Chkd	Appd.	Issue Date
P03	FOR PLANNING	KS	JL	RC	25.06.21
P02	FOR PLANNING	SG	JL	RC	12.03.21
P01	DRAFT FOR COMMENT	SG	JL	RC	27.01.21

**Cyfoeth Naturiol Cymru Natural Resources Wales**

**ARUP**

Project Name:  
**STEPHENSON STREET FLOOD DEFENCE SCHEME**

Drawing Title:  
**LIBERTY STEEL RAILWAY EMBANKMENT CULVERT**

Suitability:  
**FOR PLANNING**

Suitability Code:  
**S2**

Internal Project Number:  
**274580**

Scale:  
**AS SHOWN**

Rev.  
**P03**

Drawing Number:  
**274580-ARP-XX-XX-DR-CX-7001**

THIS DRAWING SHALL BE USED FOR THE PURPOSE OF A PLANNING APPLICATION ONLY AND SHALL NOT BE USED FOR COSTING OR CONSTRUCTION