

- Legend**
- Topographical Survey Boundary
 - Existing Utilities
 - Highway to be broken up and removed
 - Footpath to be broken up and removed
 - Vegetation to be removed and any topsoil stockpiled
 - Trees/hedges to be removed
 - Concrete to be broken up and removed
 - Compacted gravel to be removed
 - Wall/fence to be removed
 - Gully to be removed and spur capped
 - Lighting column to be removed

- Notes**
1. Do not scale from this drawing
 2. All dimensions are in metres unless noted otherwise.
 3. The details shown on this drawing are based on a RIBA Stage 4 design for approval produced for a detailed planning application. The details will need to be reviewed and revised during subsequent design stages.
 4. The topographical survey details shown within the topographical survey boundary has been provided by Natural Resources Wales (NRW) on 05/08/2020 from a survey completed by John Vincent Surveys LTD in July 2020. The survey information outside the boundary is a combination of surveys received from NRW as part of the original tender. No responsibility can be given for the accuracy of these surveys.
 5. All original services/drainage covers, chambers, valves and meters affected by the new works to be replaced and adjusted on-site to suit proposed levels.
 6. Assume all items for removal are to be disposed of off-site unless stated otherwise in advance by the design information, NRW or local authority.
 7. All handstandings and kerbs to be removed and excavation to continue until natural strata encountered unless stated otherwise.
 8. Contractor to consult with appropriate statutory authorities prior to commencement of works on their assets.
 9. Extent of reinstatement works not shown on this drawing.
 10. Site clearance shown for the proposed highway and accompanying drainage infrastructure. No allowance or site clearance shown for the proposed flood defences.
 11. Refer to ground investigation findings and reports for details of ground conditions as well as ecological surveys for any details of any invasive species.
 12. Refer to drawing 274580-ARP-XX-XX-DR-CX-1102 to 1103 for details of existing drainage and utilities.

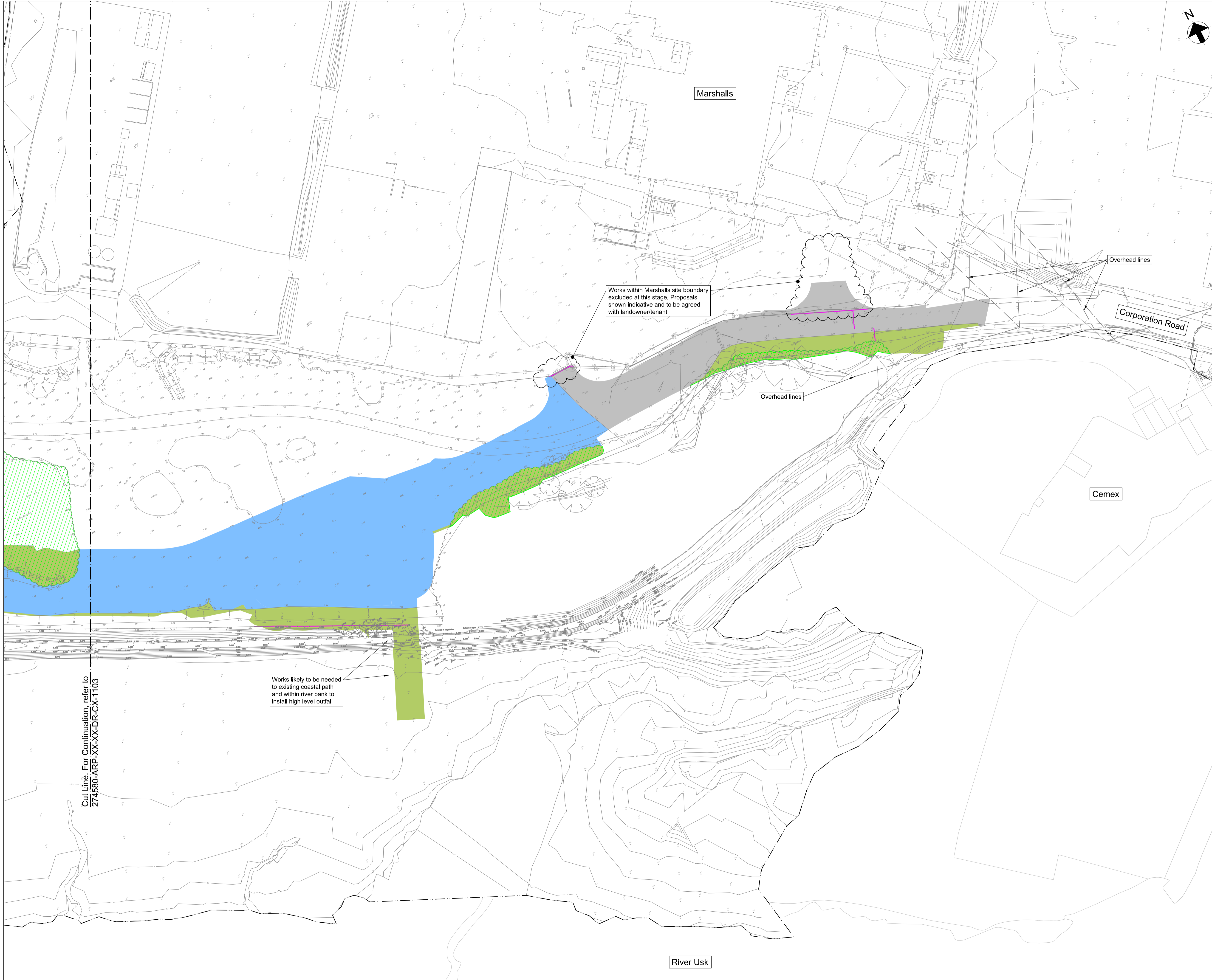

Cut Line. For Continuation, refer to 274580-ARP-XX-XX-DR-CX-1103

Works likely to be needed to existing coastal path and within river bank to install high level outfall

Works within Marshalls site boundary excluded at this stage. Proposals shown indicative and to be agreed with landowner/tenant

P03	REVISED FOR PLANNING RESUBMISSION	CB	CL	DL	25/06/21
P02	ISSUED FOR TENDER	CB	CL	DL	11/05/21
P01	ISSUED FOR PLANNING	CB	SW	SW	24/02/21
Rev.	Description	Drawn	Chkd.	Appd.	Issue Date

Cyfoeth Naturiol Cymru
Natural Resources Wales

ARUP

Project Name:
STEPHENSON STREET FLOOD DEFENCE SCHEME

Drawing Title:
**EAST BANK ROAD
SITE CLEARANCE
SHEET 2 OF 2**

Subsidiary Code: D2 - FOR TENDER	Subsidiary Code: D2
Internal Project Number: 274580	Scale: 1:500
Drawing Number: 274580-ARP-XX-XX-DR-CX-1104	Rev. P03