

- Legend**
- Existing Ground Profile
 - Proposed Vertical Alignment
 - Proposed Vertical Curve

Notes

1. For proposed highway contours refer to drawing 274580-ARP-XX-XX-DR-CX-1010 and 1011.

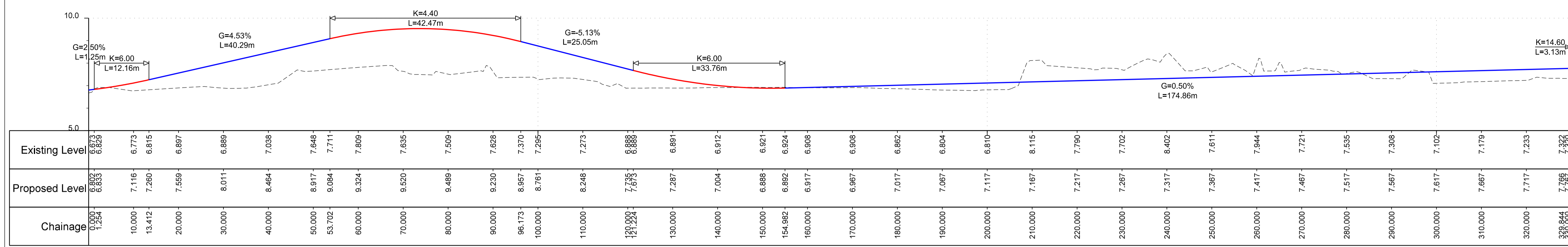

Alignment CL 01 chainage 0m - 330m
1:500 Horiz; 1:100 Vert

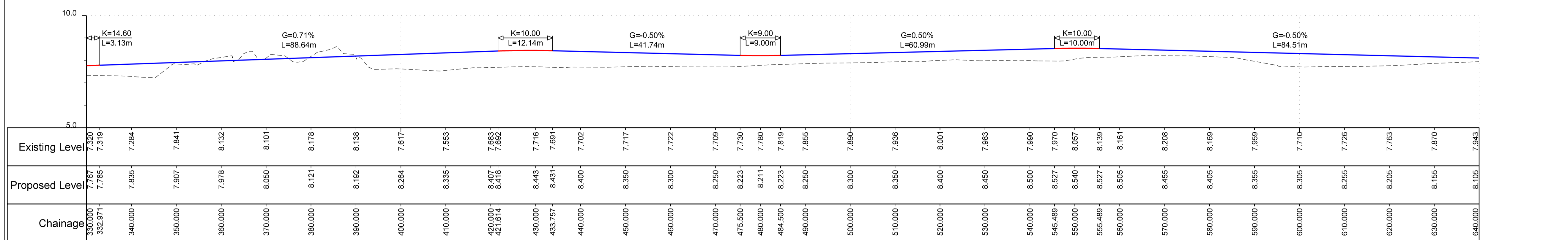

Alignment CL 01 chainage 330m - 640m
1:500 Horiz; 1:100 Vert

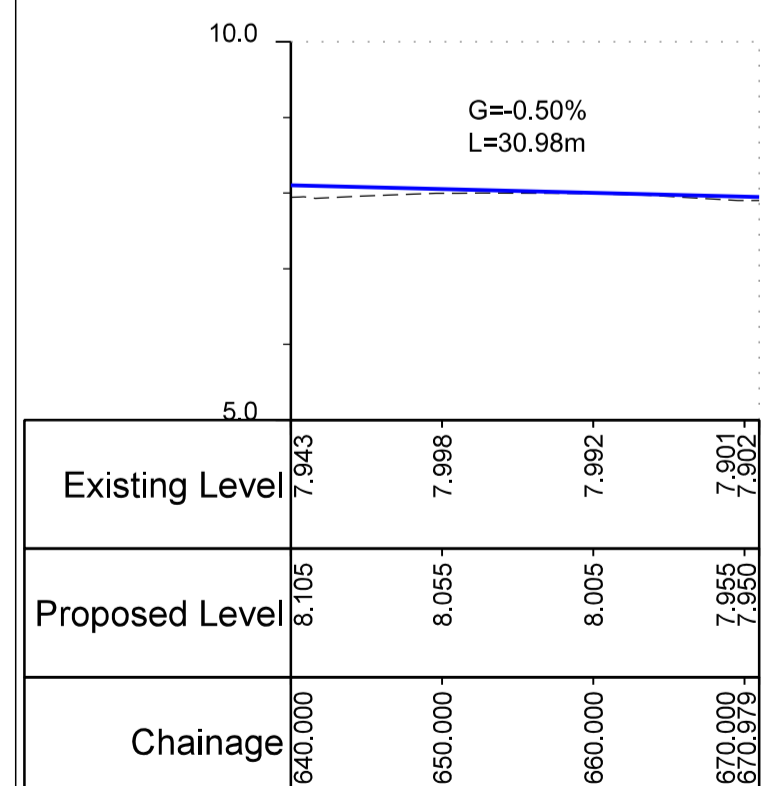

Alignment CL 01 chainage 640m - End
1:500 Horiz; 1:100 Vert

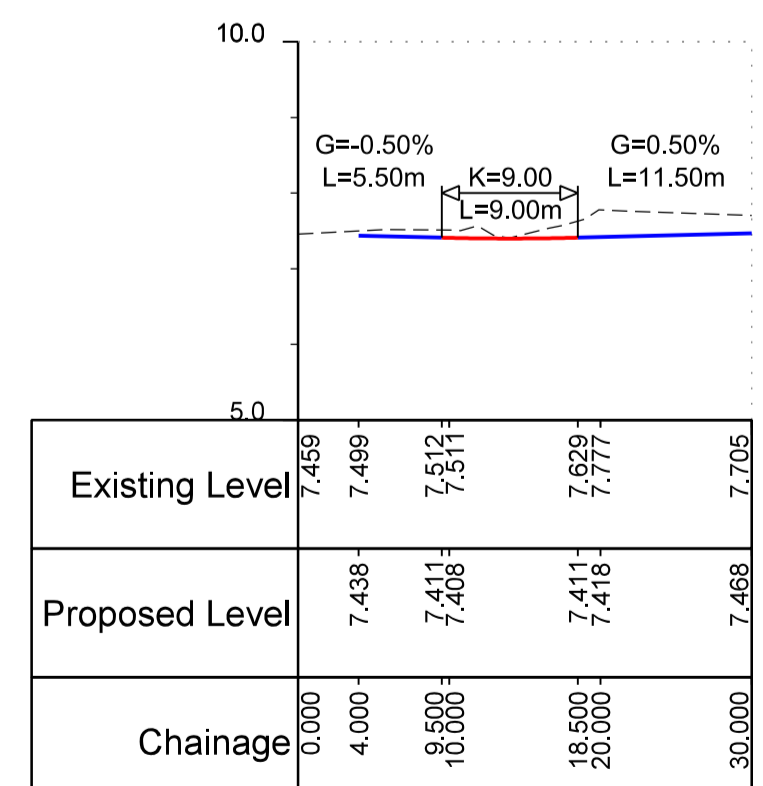

Alignment CL 02
1:500 Horiz; 1:100 Vert

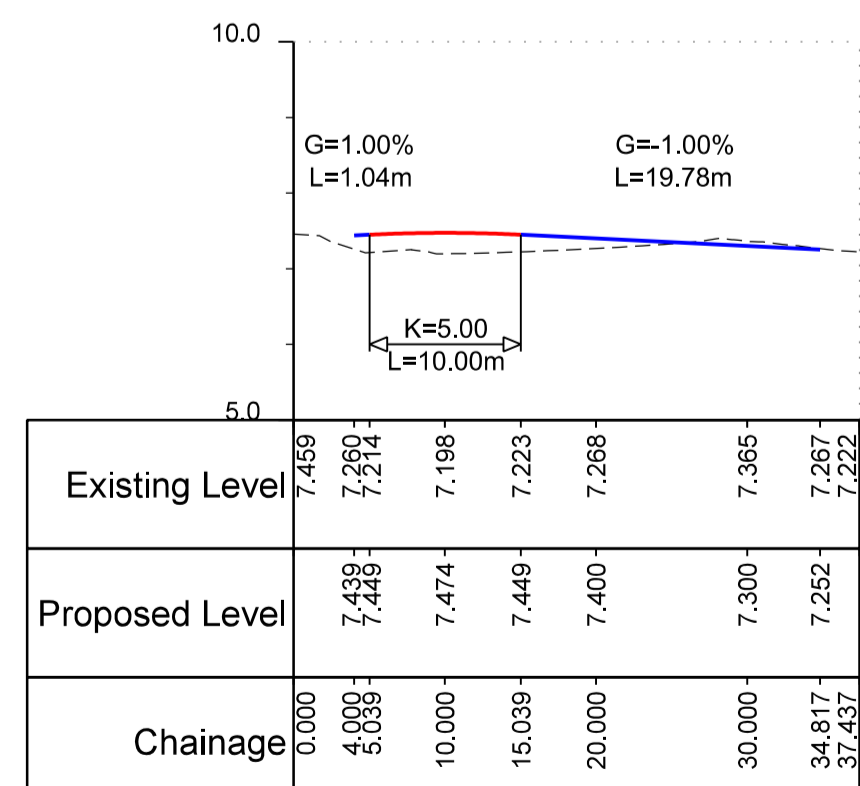

Alignment CL 03
1:500 Horiz; 1:100 Vert

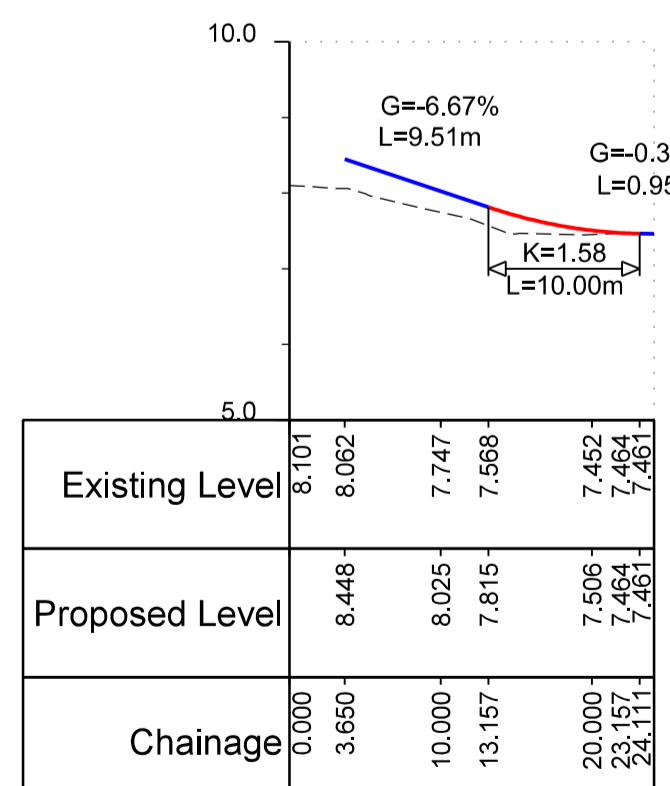

Alignment CL 04
1:500 Horiz; 1:100 Vert

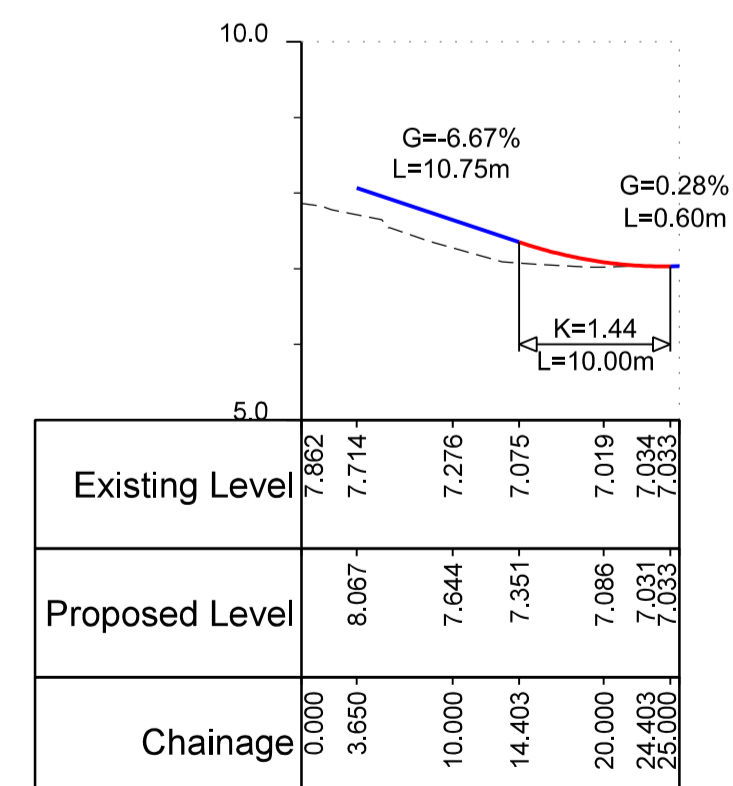

Alignment CL 05
1:500 Horiz; 1:100 Vert

P02	ISSUED FOR TENDER	CB	CL	DL	11/05/21
P01	ISSUED FOR PLANNING	CB	SW	SW	24/02/21
Rev.	Description	Drawn	Chkd.	Appd.	Issue Date



Project Name:
STEPHENSON STREET FLOOD DEFENCE SCHEME

Drawing Title:
EAST BANK ROAD
HIGHWAY LONG SECTION

Subsidiary:
D2 - FOR TENDER

Internal Project Number:
274580

Drawing Number:
274580-ARP-XX-XX-DR-CX-1140

Scale:
1:500

Rev.
P02

THIS MAP IS BASED UPON THE ORIGINATOR'S SURVEY MATERIAL WITH THE PERMISSION OF ORIGINATOR. THE DESIGN AND DRAWING IS CONFIDENTIAL AND ALL RIGHTS THEREIN INCLUDING COPYRIGHT AND DESIGN RIGHT ARE THE PROPERTY OF NATURAL RESOURCES WALES AND SHOULD NOT BE DISCLOSED TO A THIRD PARTY OR REPRODUCED WITHOUT PRIOR CONSENT OF NATURAL RESOURCES WALES 2020